

J.L. WINGERT CO.

Specification Sheet OVERFLOW BASINS MODEL []-OF

SS130026.C 02/17

SPECIFICATIONS

KEY	DESCRIPTION
1	BASIN: Constructed of 1/8" thick yellow polyethylene with 2" FNPT level / viewing port

DIMENSIONS

GALLONS	A	B	C	WEIGHT
80	23"	32" diameter	25" diameter	19 lbs. approx.
150	37"	36" diameter	31" diameter	35 lbs. approx.
275	39"	48" diameter	38" diameter	50 lbs. approx.
425	37"	60" diameter	49.5" diameter	78 lbs. approx.
625	53"	60" diameter	49.5" diameter	112 lbs. approx.
800	68"	60" diameter	49.5" diameter	165 lbs. approx.

NOTE: Place gallons inside [] for complete part number.

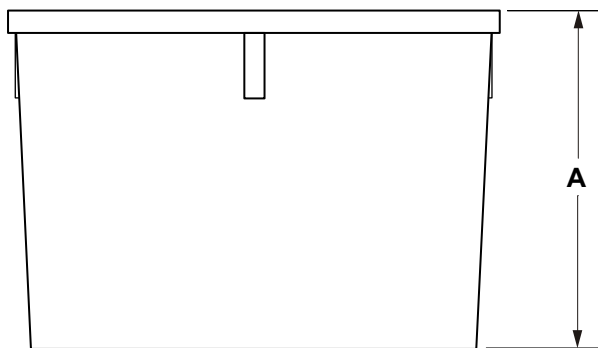
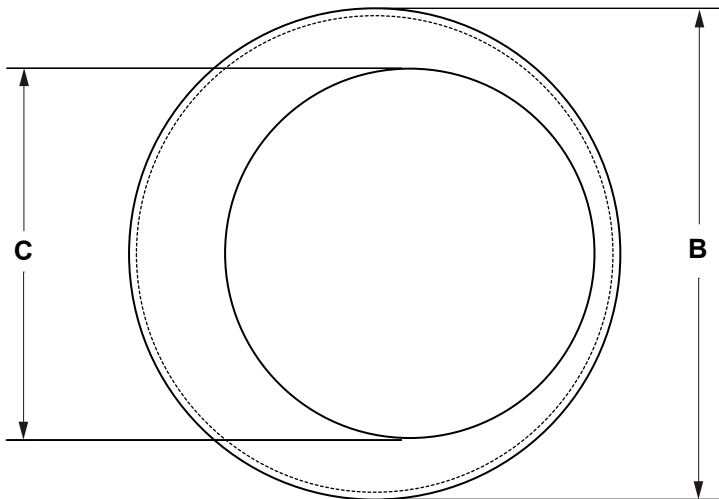

Note: All dimensions are +/- 1/8". All weights are approximate. All dimensions are subject to change without notice.

MANUFACTURING: Mixers, Bypass Feeders, Filter Feeders, Bromine Feeders, Sample Coolers, Sludge Traps, Separators, Separator Systems, Tank Stands, Tank Package Systems, Glycol Feed Systems, Coupon Racks, Control Stations, NEMA Enclosures, Custom Packaged Systems and Specialty Welding

P.O. Box 6207 | Garden Grove, CA 92846-6207 | 11800 Monarch St. | Garden Grove, CA 92841-2113 | Phone (714) 379-5519 | Fax (714) 379-5549
Northern California Region | Phone (510) 487-5310 | Southwest Region | Phone (602) 470-1015 | Email: customerservice@jllwingert.com

www.jllwingert.com